

Port of Skagit - SWIFT Center Building 22 and 25 Reroof Project

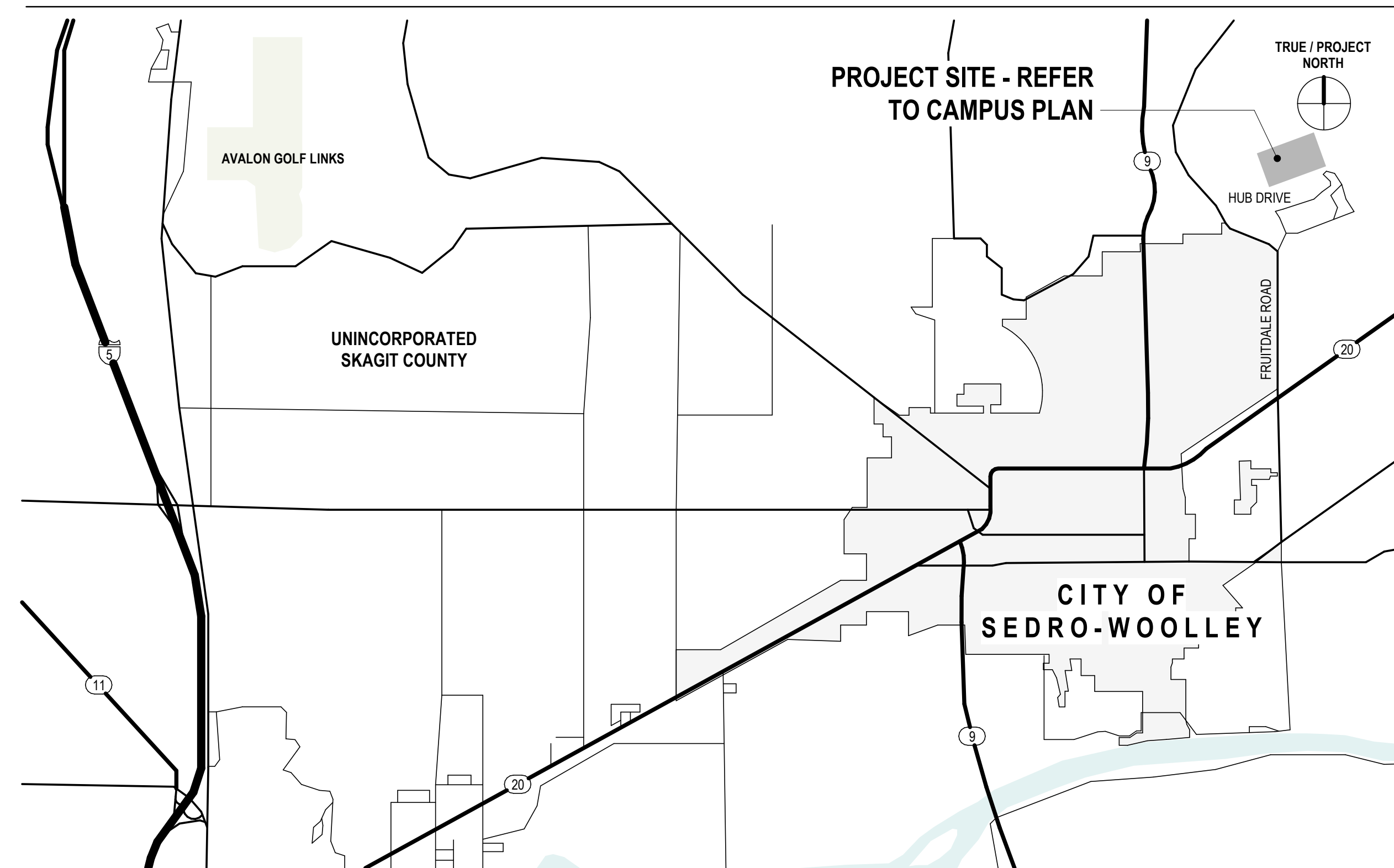

Aerial Photo of Existing Campus NOTE: THIS IMAGE IS FOR ILLUSTRATIVE PURPOSES ONLY. IT IS NOT TO SCALE, AND NOT TO BE USED FOR DESIGN, PERMITTING, BIDDING, OR CONSTRUCTION.

Vicinity Map



Project Team

CLIENT:
PORT OF SKAGIT
15400 AIRPORT DRIVE
BURLINGTON, WA 98233
T 360 757 0011
BRADY ROWE
BRADY@PORTOFKAGIT.COM
TRAVIS SINSCHUS
TRAVIS@PORTOFKAGIT.COM

ARCHITECT:
RMC ARCHITECTS, PLLC
1223 RAILROAD AVENUE
BELLINGHAM, WA 98225
T 360 676 7733
JASON WILLIARD
JASON.W@RMCARCHITECTS.COM

HAZARDOUS MATERIALS SURVEY:
PBS ENGINEERING AND ENVIRONMENTAL, INC.
214 EAST GALER STREET
SEATTLE, WA 98102
T 206 233 9539
MARK HILEY
MARK.HILEY@PBSUSA.COM

Drawing Index

GENERAL

G001 COVER SHEET

ARCHITECTURAL

A100 EXISTING CAMPUS PLAN
A200 BUILDING 22 (PLUMBING AND CARPENTRY SHOP) DEMOLITION AND PROPOSED ROOF PLANS
A201 BUILDING 25 (PLANNER SHOP) DEMOLITION AND PROPOSED ROOF PLANS
A400 TYPICAL ROOF DETAILS AT COMPOSITION ROOF REPLACEMENT
A401 ROOF DETAILS AT BUILDING 22 (PLUMBING AND CARPENTRY SHOP) CANOPIES

Project Information

PROJECT DATA

SITE ADDRESS: BUILDING 22 (SOUTH, PLUMBING SHOP) - 2085 POWERHOUSE DRIVE
BUILDING 22 (NORTH, CARPENTER / ELECTRIC SHOP) - 2111 POWERHOUSE DRIVE
BUILDING 25 (PLANNER SHOP) - 2092 POWERHOUSE DRIVE

PARCEL NUMBER: SKAGIT COUNTY ID NO. P38607 (PARCEL A), P39356 (PARCEL B), P100646 (PARCEL C), P100632 (PARCEL D)
LEGAL DESCRIPTION: PARCELS (NOTED ABOVE) LEGAL DESCRIPTIONS ARE FULLY DESCRIBED IN TRANSFER AGREEMENT BETWEEN DEPARTMENT OF ENTERPRISE SERVICES FOR THE STATE OF WASHINGTON AND THE PORT OF SKAGIT COUNTY, AND CAN ALSO BE FOUND AT THE OFFICE OF THE SKAGIT COUNTY ASSESSOR

PROJECT DESCRIPTION:
BASE BID: BUILDING 22, PORT OF SKAGIT MAINTENANCE SHOPS (PLUMBING AND CARPENTER SHOP) - REMOVAL OF EXISTING ASPHALT ROOFING SHINGLES TO EXISTING SHEATHING. INSTALLATION OF NEW PLYWOOD SHEATHING ABOVE, AND REPLACEMENT OF UNDERLAYMENT, FLASHINGS, ASPHALT ROOFING SHINGLES, GUTTERS AND DOWNSPOUTS AT AREAS LOCATED ON PLANS.
BASE BID: BUILDING 25, CJCC CAREER SERVICES (PLANNER SHOP) - REMOVAL OF EXISTING ASPHALT ROOFING SHINGLES TO EXISTING SHEATHING, AND REPLACEMENT OF UNDERLAYMENT, FLASHINGS, ASPHALT ROOFING SHINGLES, GUTTERS AND DOWNSPOUTS AT AREAS LOCATED ON PLANS.

DEFERRED PERMIT SUBMITTALS: TBD
ZONING: CITY OF SEDRO-WOOLLEY, PUBLIC (P) - REFER TO SWMC 17.32

BUILDING CODE REQUIREMENTS

CODES: INTERNATIONAL BUILDING CODE (IBC), 2018 EDITION
INTERNATIONAL EXISTING BUILDING CODE (IEBC), 2018 EDITION
INTERNATIONAL MECHANICAL CODE (IMC), 2018 EDITION
INTERNATIONAL FUEL GAS CODE (IFGC), 2018 EDITION
INTERNATIONAL FIRE CODE (IFC), 2018 EDITION
UNIFORM PLUMBING CODE (UPC), 2018 EDITION
WASHINGTON ADMINISTRATIVE CODE (WAC) CHAPTER 296-46b, NATIONAL ELECTRIC CODE (NEC), 2017
WASHINGTON STATE ENERGY CODE (WSEC), 2016 EDITION

*NOTE: ALL CODES ARE SUBSEQUENTLY MODIFIED BY WASHINGTON ADMINISTRATIVE CODE (WAC) AMENDMENTS

SELECTED CODE / APPROACH: IEBC, PRESCRIPTIVE COMPLIANCE METHOD (IEBC 301.1.1)

OCCUPANCY CLASSIFICATION: BUSINESS (B), TYPICAL

CONSTRUCTION TYPE: VARIOUS

FIRE PROTECTION: N/A

ALLOWABLE HEIGHT AND AREA: N/A

AREA SUMMARY: N/A

PARKING COUNT: N/A

Architectural Symbols

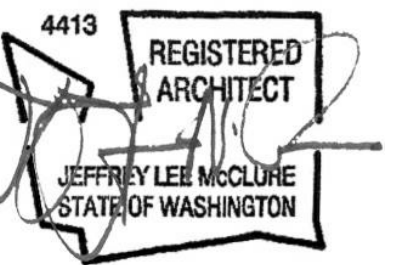
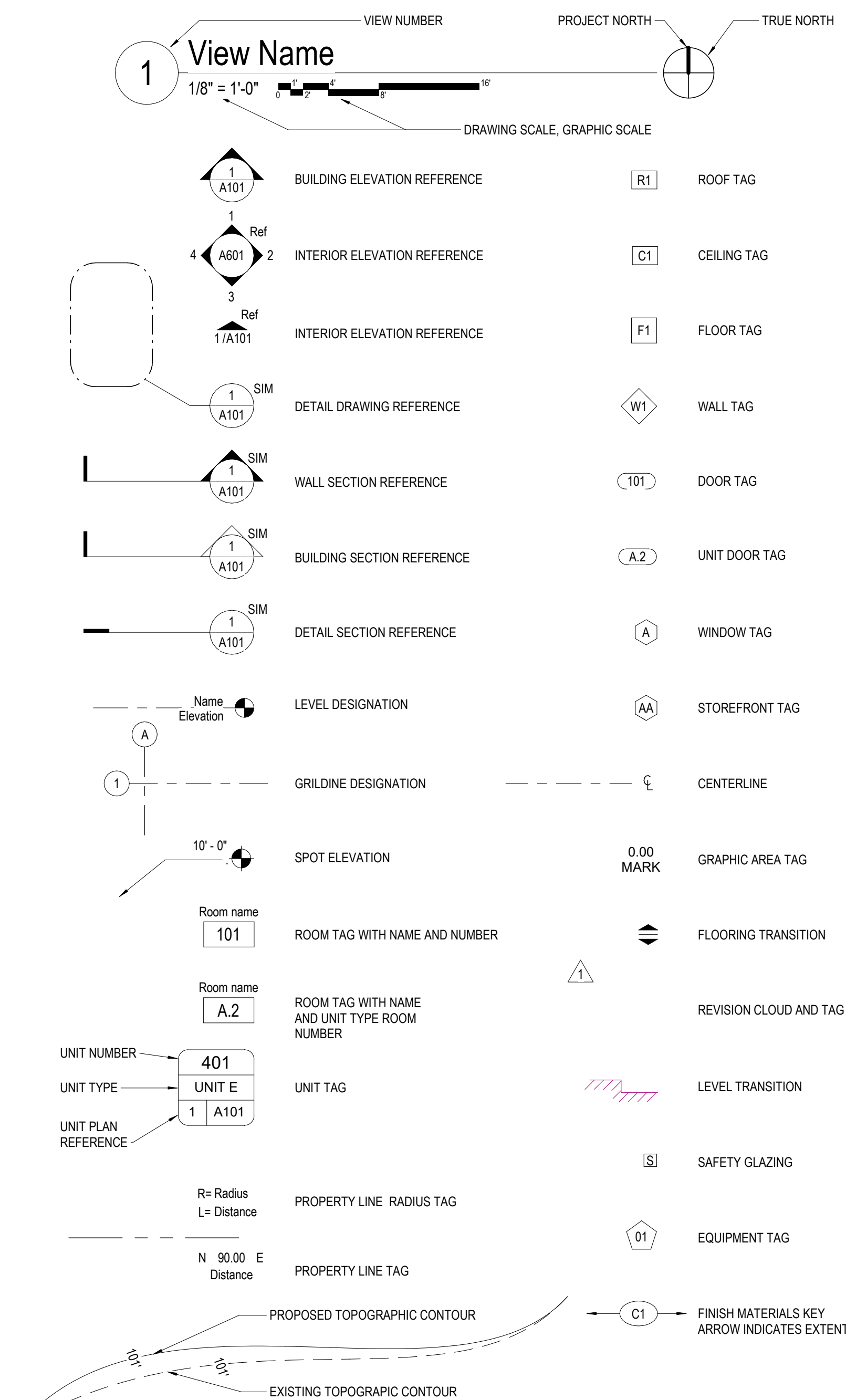

Port of Skagit - SWIFT Center
Building 22 and 25 Reroof Project
 Northern State Hospital Campus
 Sedro-Woolley, WA 98284

Job No: 2228 Date: 2022-06-15
 File No: 2228 2022 Reroof Projects
 Drawn By: JWillard
 Checked By: JMcClure
 Issued for: BID / PERMIT

COVER SHEET

G001

BID / PERMIT 2022-06-15

DIMENSIONS AND LOCATION OF PROPOSED STAGING AREA TO BE COORDINATED WITH OWNER PRIOR TO CONSTRUCTION

2 A201

2 A200

BUILDING 25 (PLASTER SHOP) AREA OF WORK

BUILDING 22 (PLUMBING AND CARPENTER SHOP) AREA OF WORK

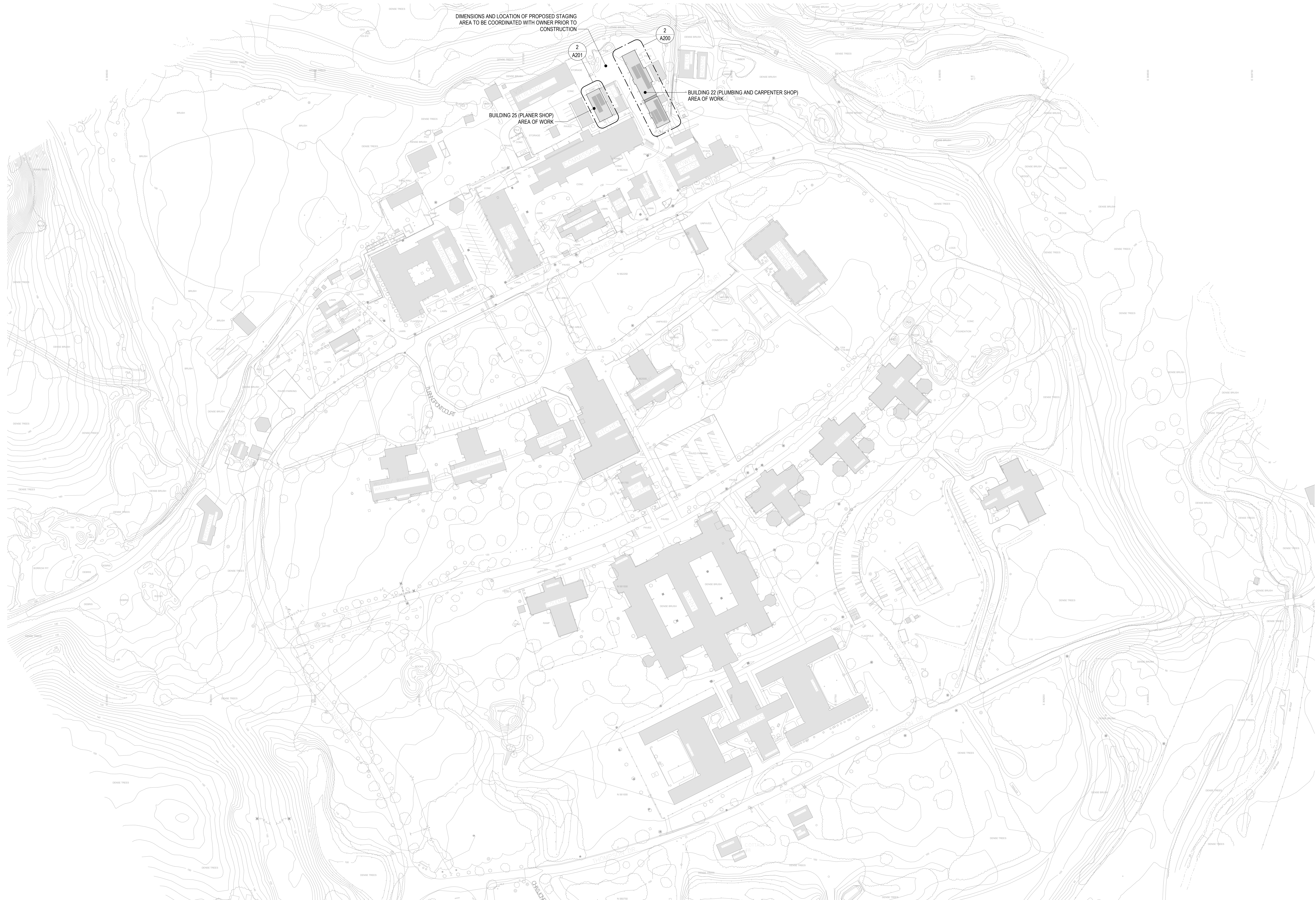

1 Existing Campus Plan
1" = 100'-0"

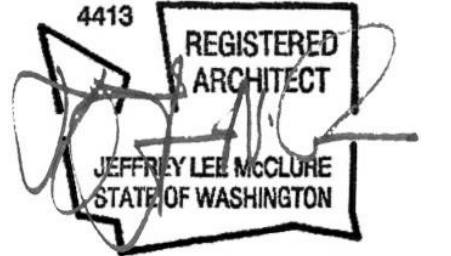

Port of Skagit - SWIFT Center
Building 22 and 25 Reroof Project
Northern State Hospital Campus
Sedro-Woolley, WA 98284

Job No: 2228 Date: 2022-06-15
File No: 2228 2022 Reroof Projects
Drawn By: JWillard
Checked By: JMcClure
Issued for: BID / PERMIT

EXISTING CAMPUS PLAN

NOTE: CONTRACTOR TO PROVIDE UNIT PRICES AS AN ALLOWANCE AMOUNT AS DEFINED WITHIN THE PROJECT SPECIFICATIONS AND BID FORM. ALLOWANCES ARE TO PROVIDE FOR REPLACEMENT OF DAMAGED / UNSUITABLE ROOF SHEATHING AND WOOD FASCIA. AREAS OF WORK TO BE NOTED AND REVIEWED BY ARCHITECT AND OWNER PRIOR TO REPLACEMENT.

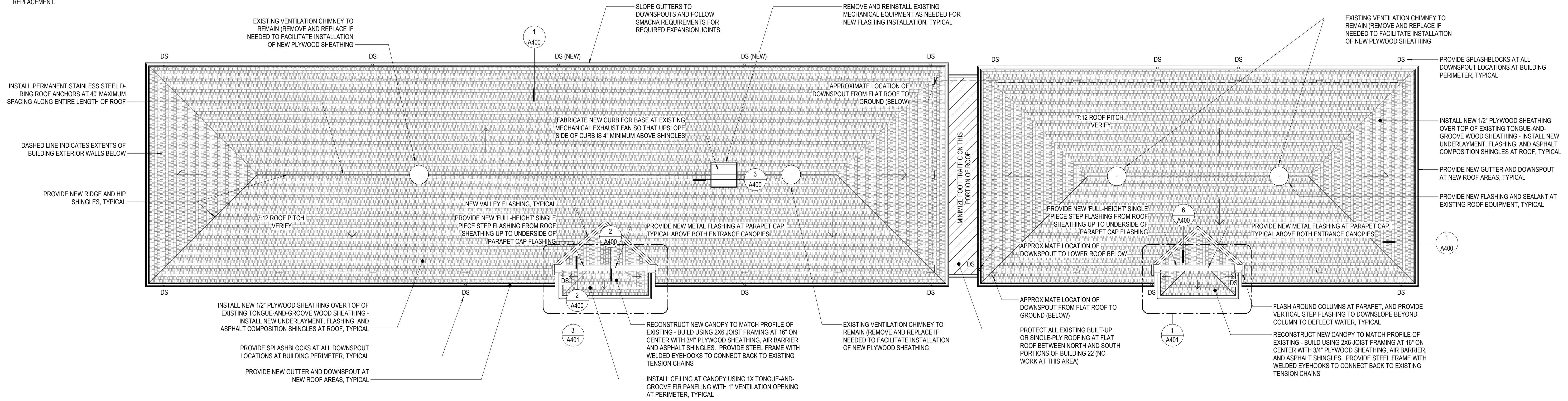

2 Building 22 Roof Proposed Plan
1/8" = 1'-0"

NOTE: CONTRACTOR TO PROVIDE UNIT PRICES AS AN ALLOWANCE AMOUNT AS DEFINED WITHIN THE PROJECT SPECIFICATIONS AND BID FORM. ALLOWANCES ARE TO PROVIDE FOR REPLACEMENT OF DAMAGED / UNSUITABLE ROOF SHEATHING AND WOOD FASCIA. AREAS OF WORK TO BE NOTED AND REVIEWED BY ARCHITECT AND OWNER PRIOR TO REPLACEMENT.

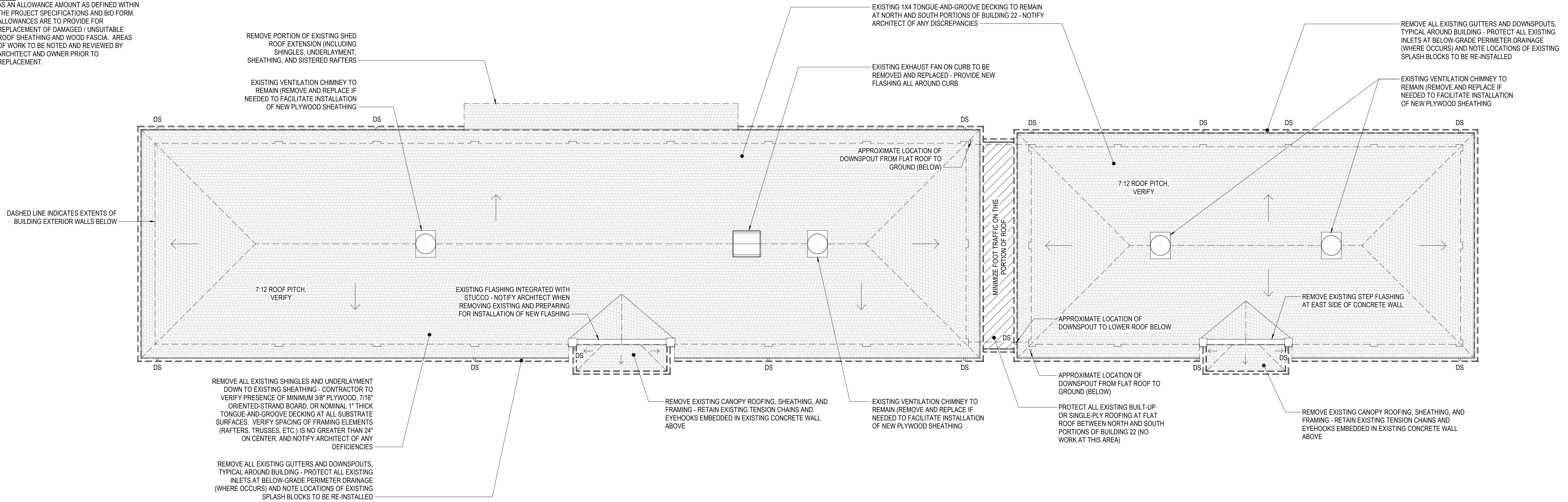

1 Building 22 Roof Demolition Plan
1/8" = 1'-0"

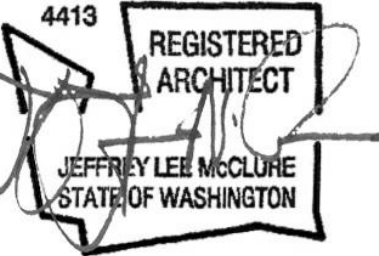

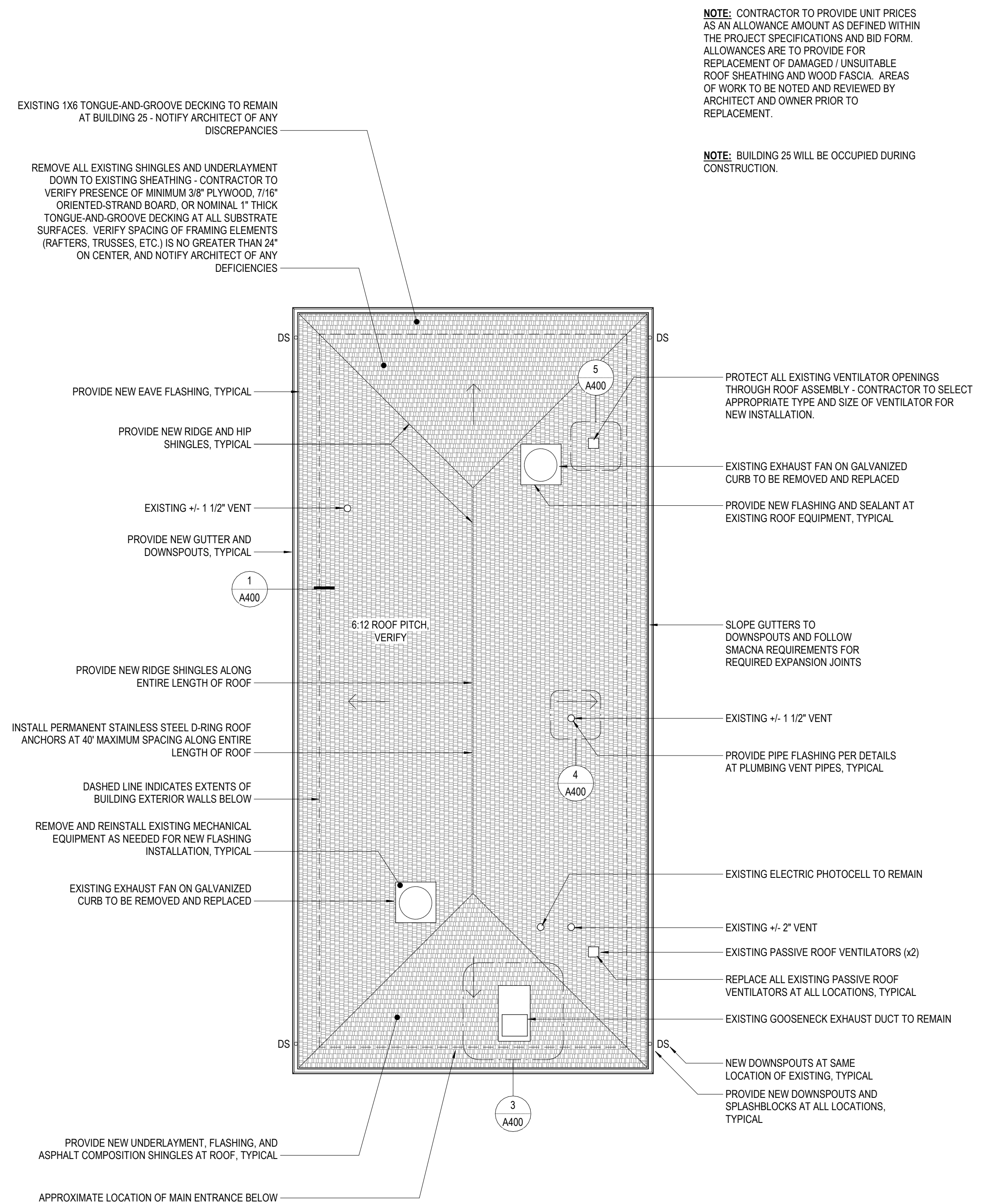
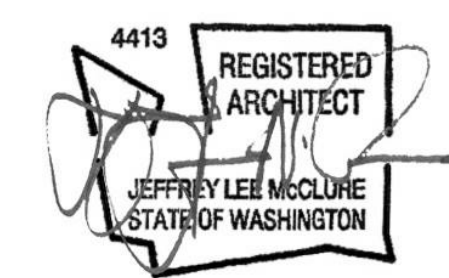

2 Building 25 Roof Proposed Plan
 1/8" = 1'-0" 0 1/2 1 2 3 4 5 6 8 16'

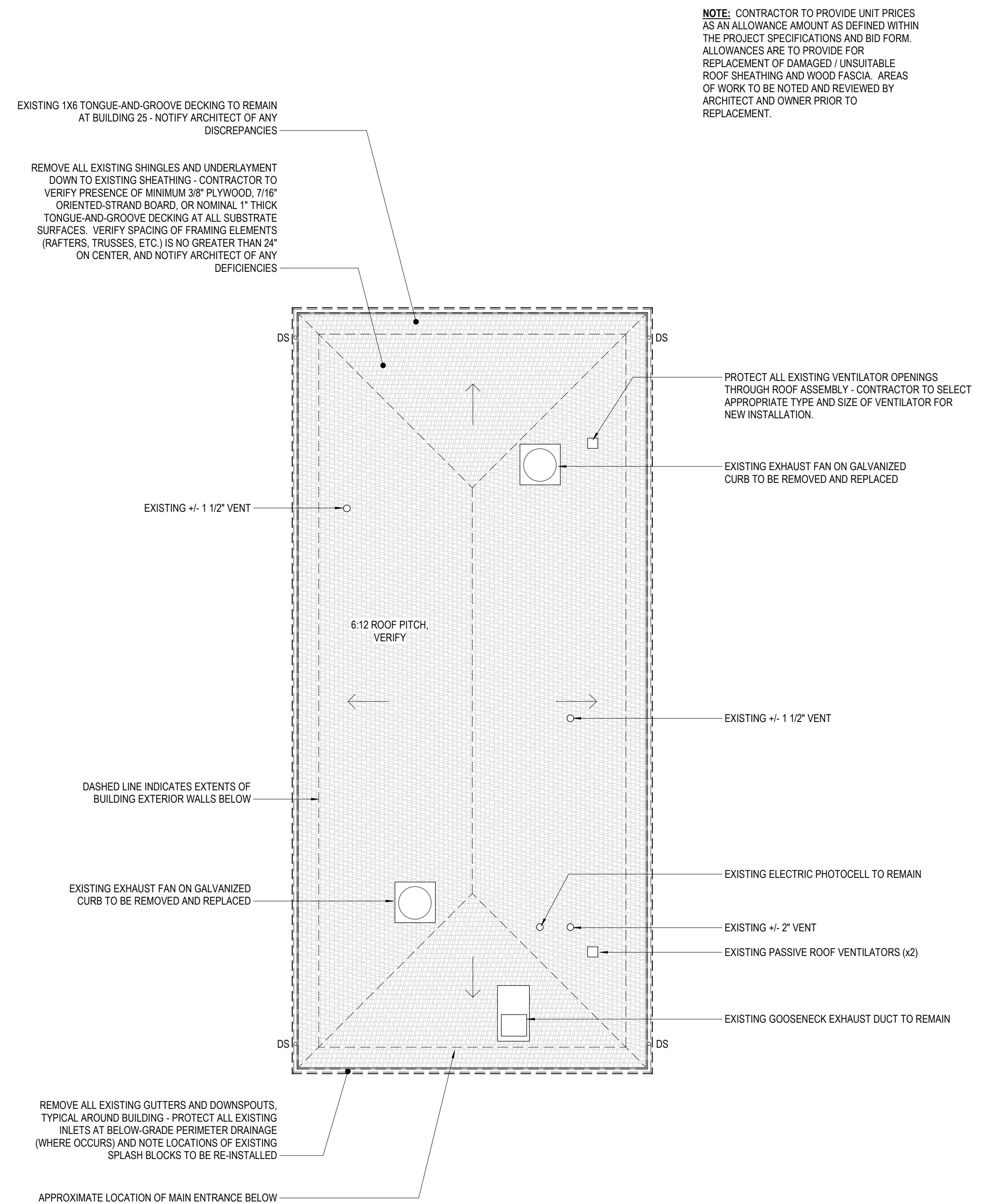

1 Building 25 Roof Demolition Plan
 1/8" = 1'-0" 0 1/2 1 2 3 4 5 6 8 16'

Port of Skagit - SWIFT Center
Building 22 and 25 Reroof Project
 Northern State Hospital Campus
 Sedro-Woolley, WA 98284

Job No: 2228 Date: 2022-06-15
 File No: 2228 2022 Reroof Projects
 Drawn By: JWillard
 Checked By: JMcClure
 Issued for: BID / PERMIT

BUILDING 25
 (PLANER SHOP)
 DEMOLITION AND
 PROPOSED ROOF
 PLANS

A201

NOTES:
 1. INCREASE EXPOSURE OF VALLEY FLASHING 1" FOR EVERY 8'-0" OF VALLEY RUN TOWARDS EAVES.

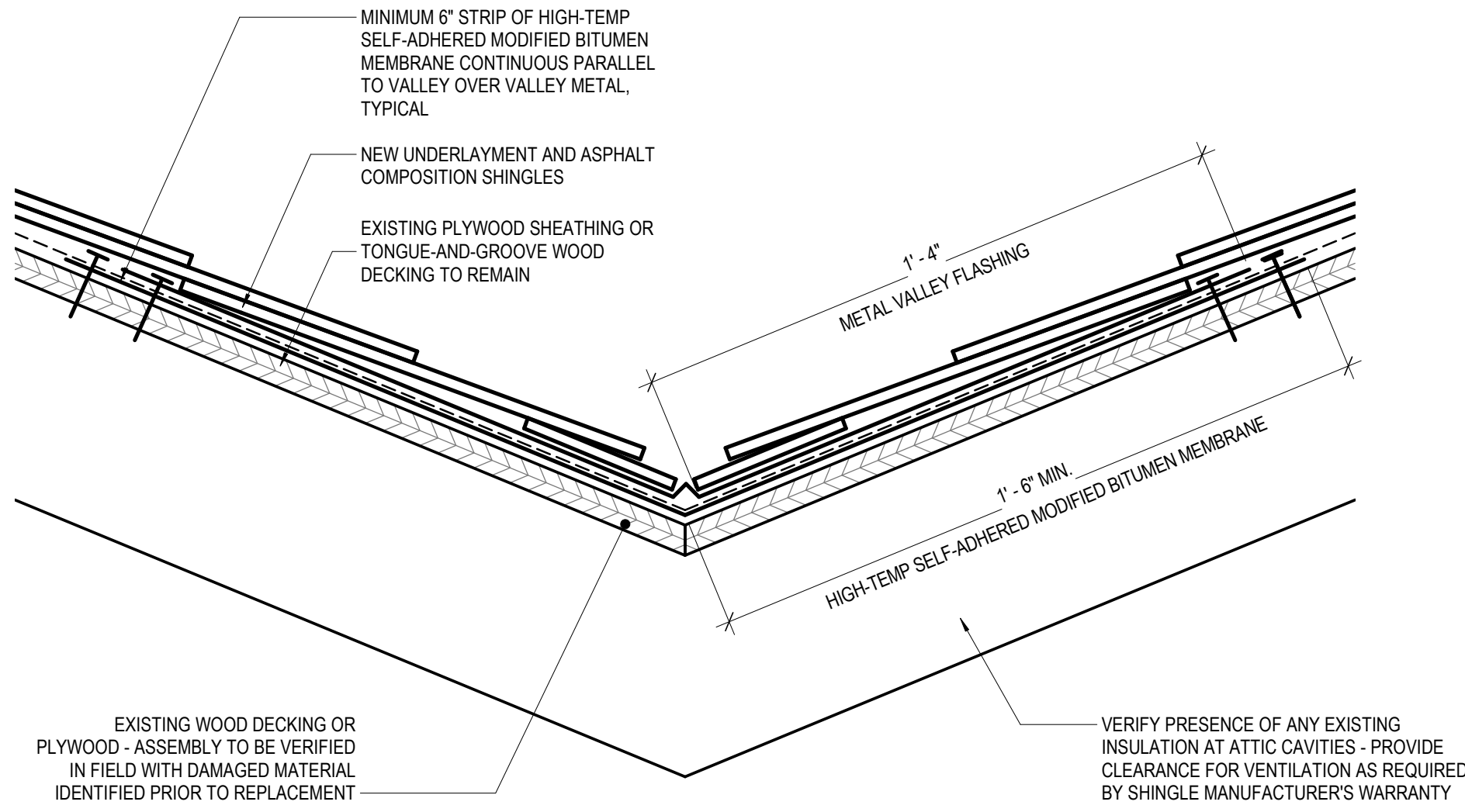

6 Valley Flashing Detail
 3" = 1'-0"

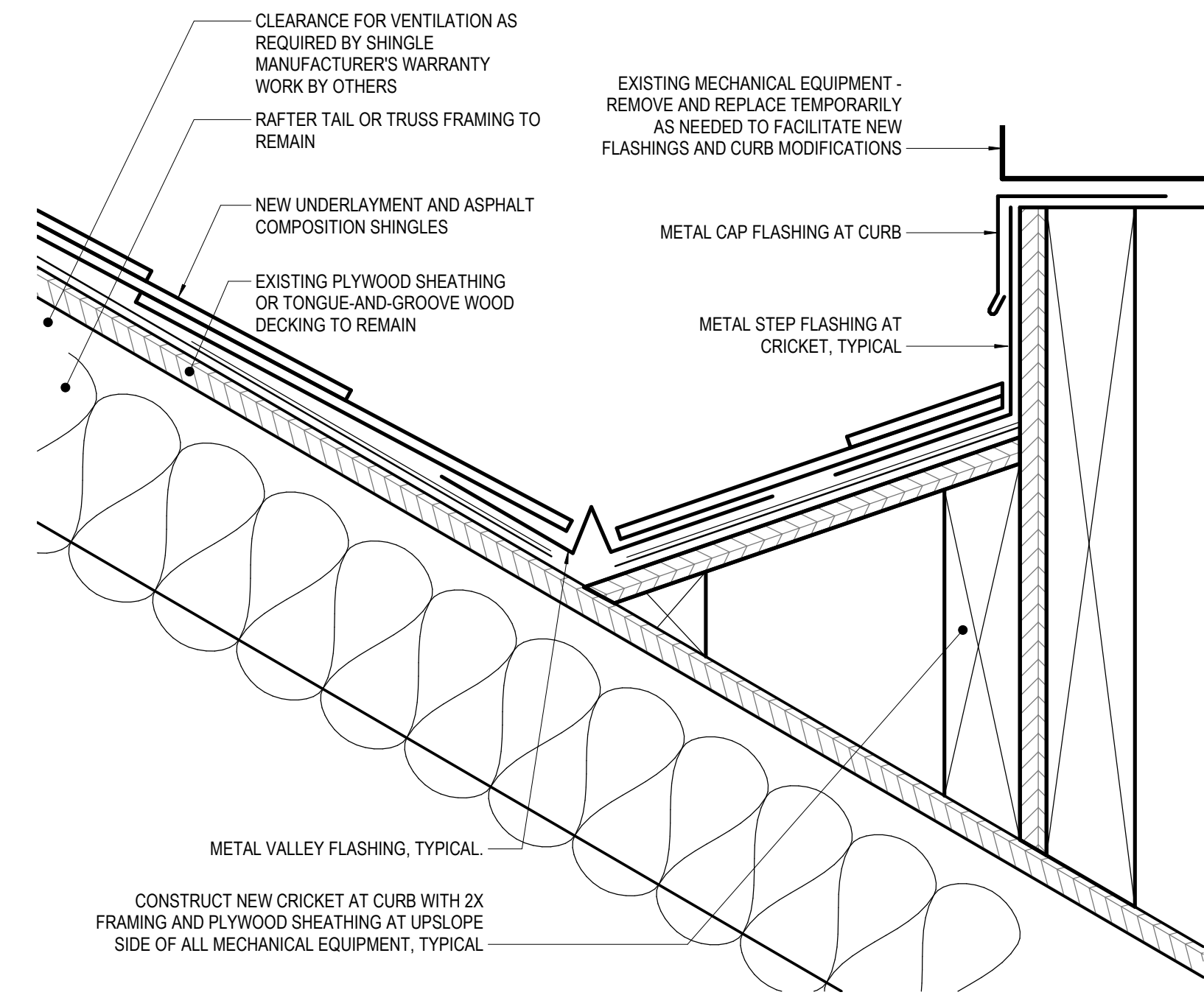

3 Typical Mechanical Curb Detail
 3" = 1'-0"

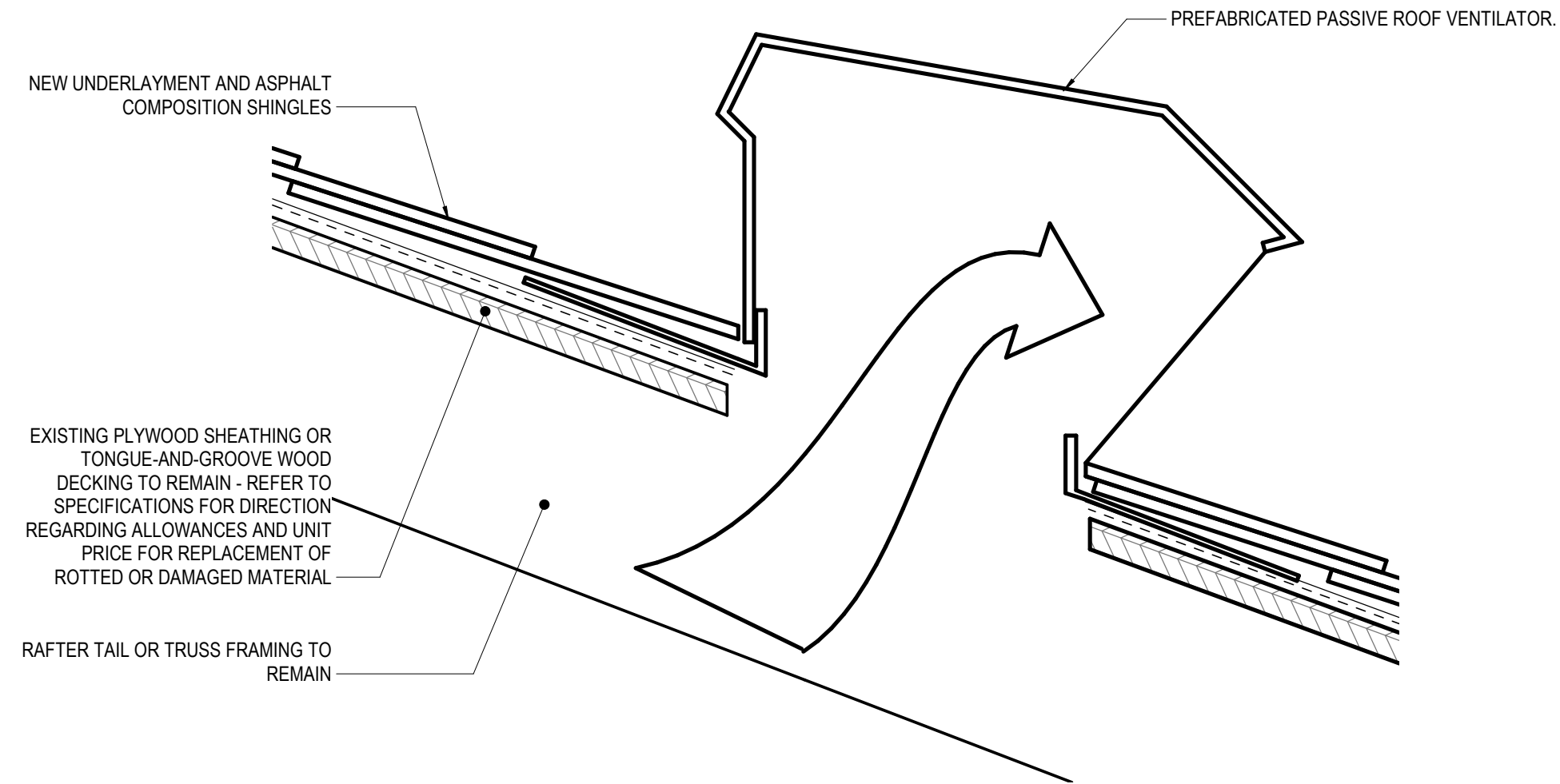

5 Typical Roof Ventilator Detail
 3" = 1'-0"

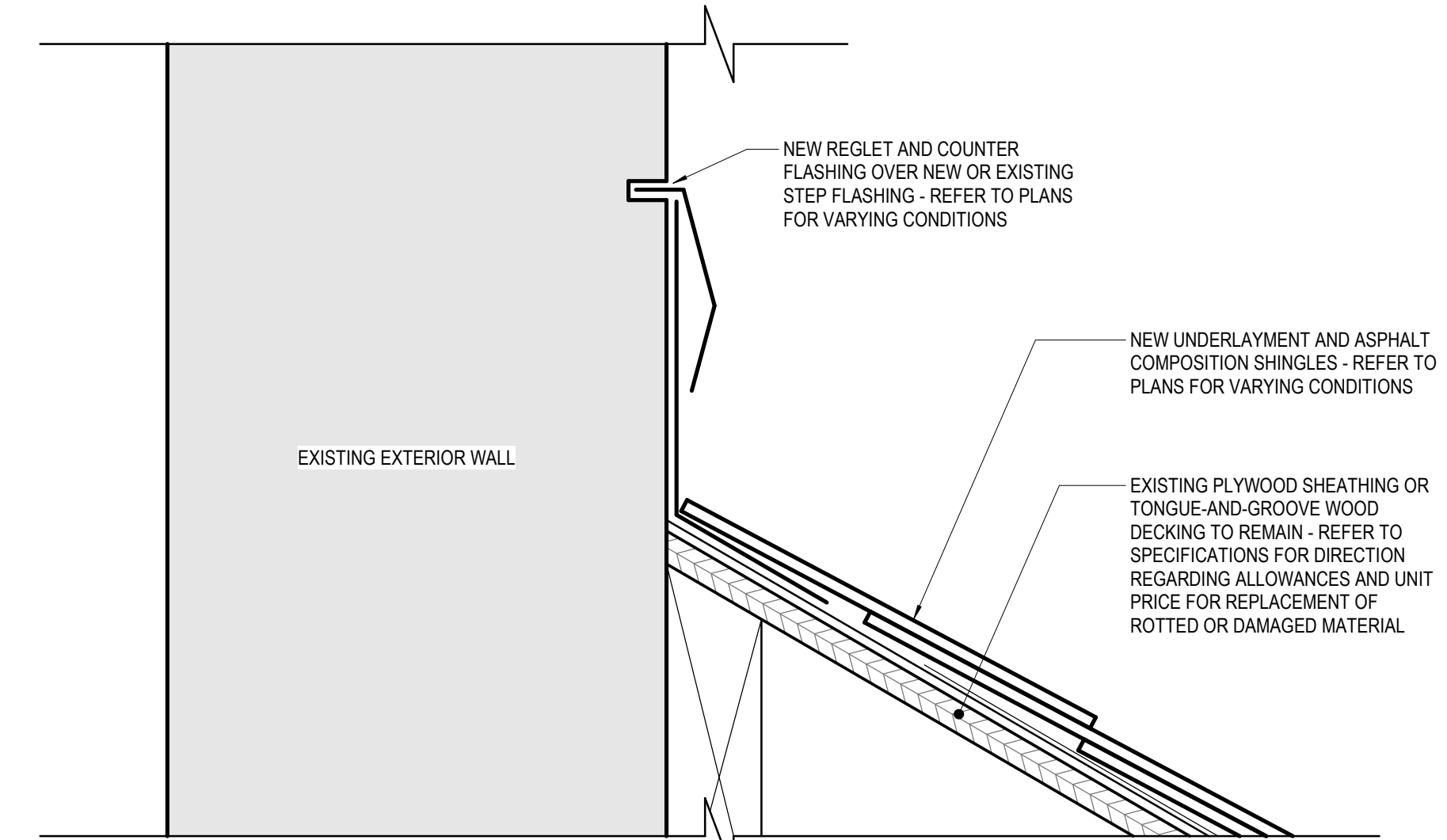

2 Typical Reglet Flashing at Wall
 3" = 1'-0"

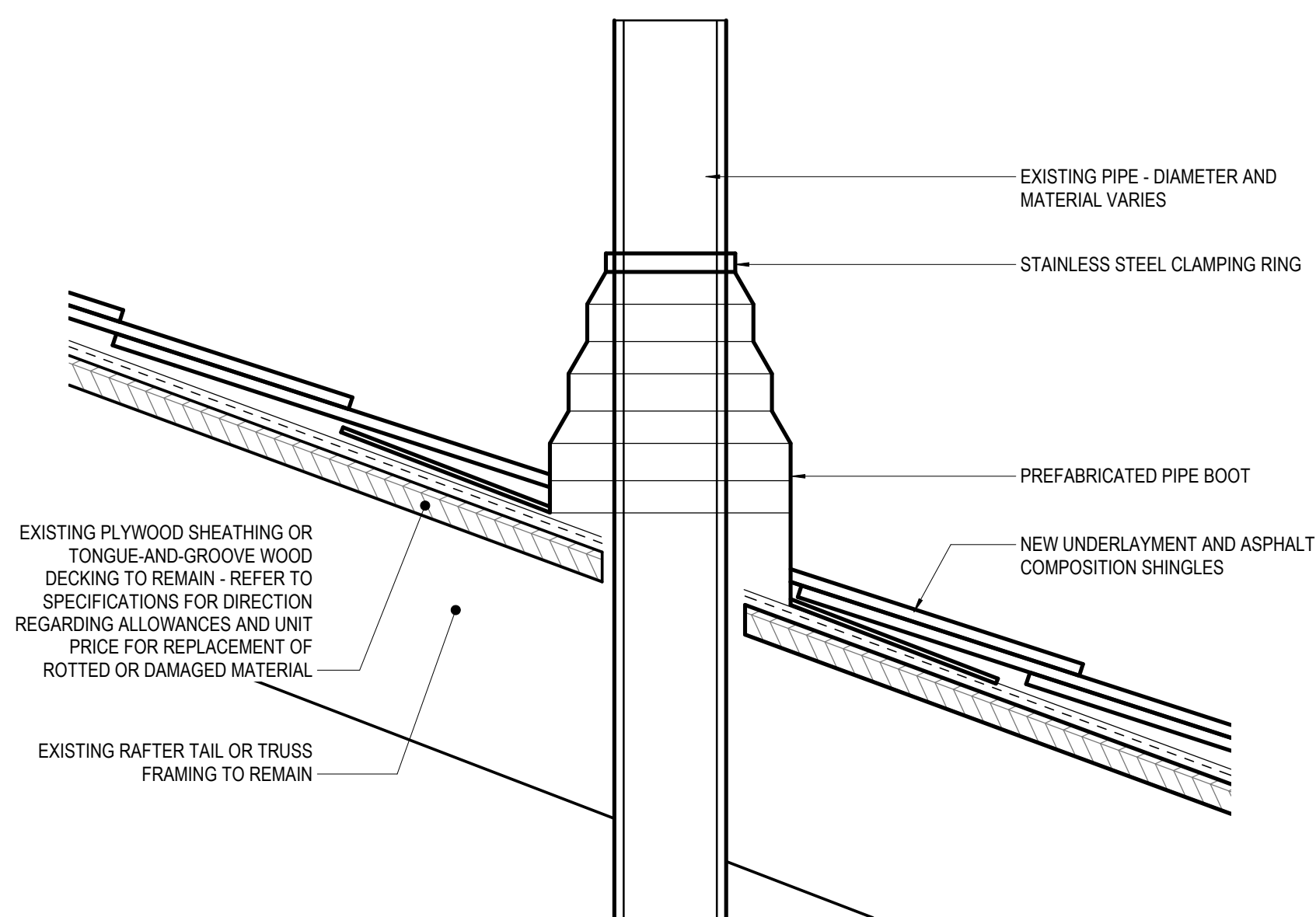

4 Typical Vent Pipe Penetration Detail
 3" = 1'-0"

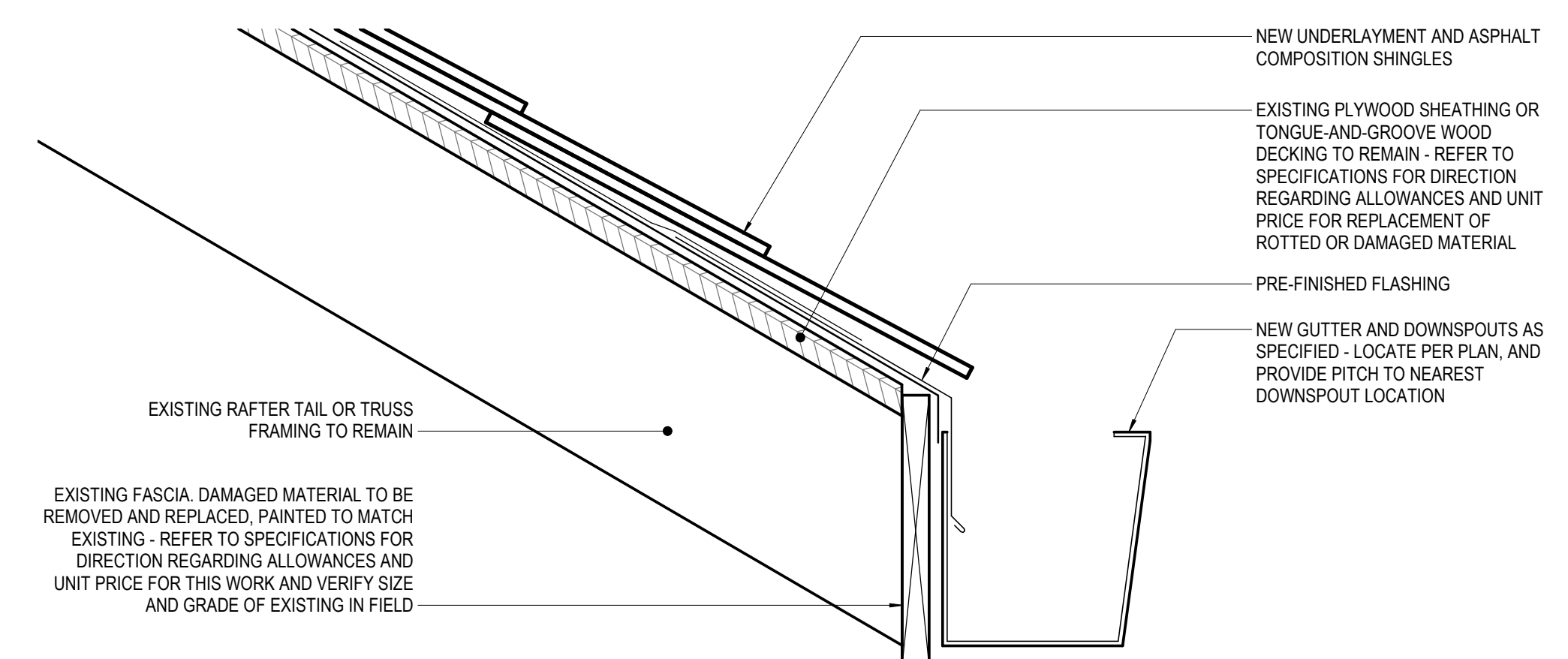

1 Typical Eave Section Detail
 3" = 1'-0"

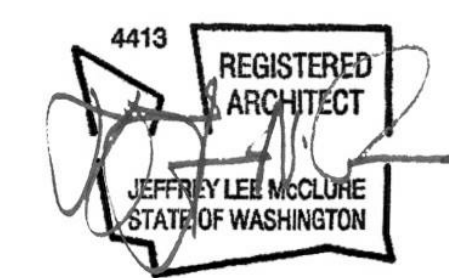

Port of Skagit - SWIFT Center
Building 22 and 25 Reroof Project
 Northern State Hospital Campus
 Sedro-Woolley, WA 98284

Job No: 2228 Date: 2022-06-15
 File No: 2228 2022 Reroof Projects
 Drawn By: JWillard
 Checked By: JMcClure
 Issued for: BID / PERMIT

ROOF DETAILS AT
 BUILDING 22
 (PLUMBING AND
 CARPENTRY SHOP)
 CANOPIES

A401

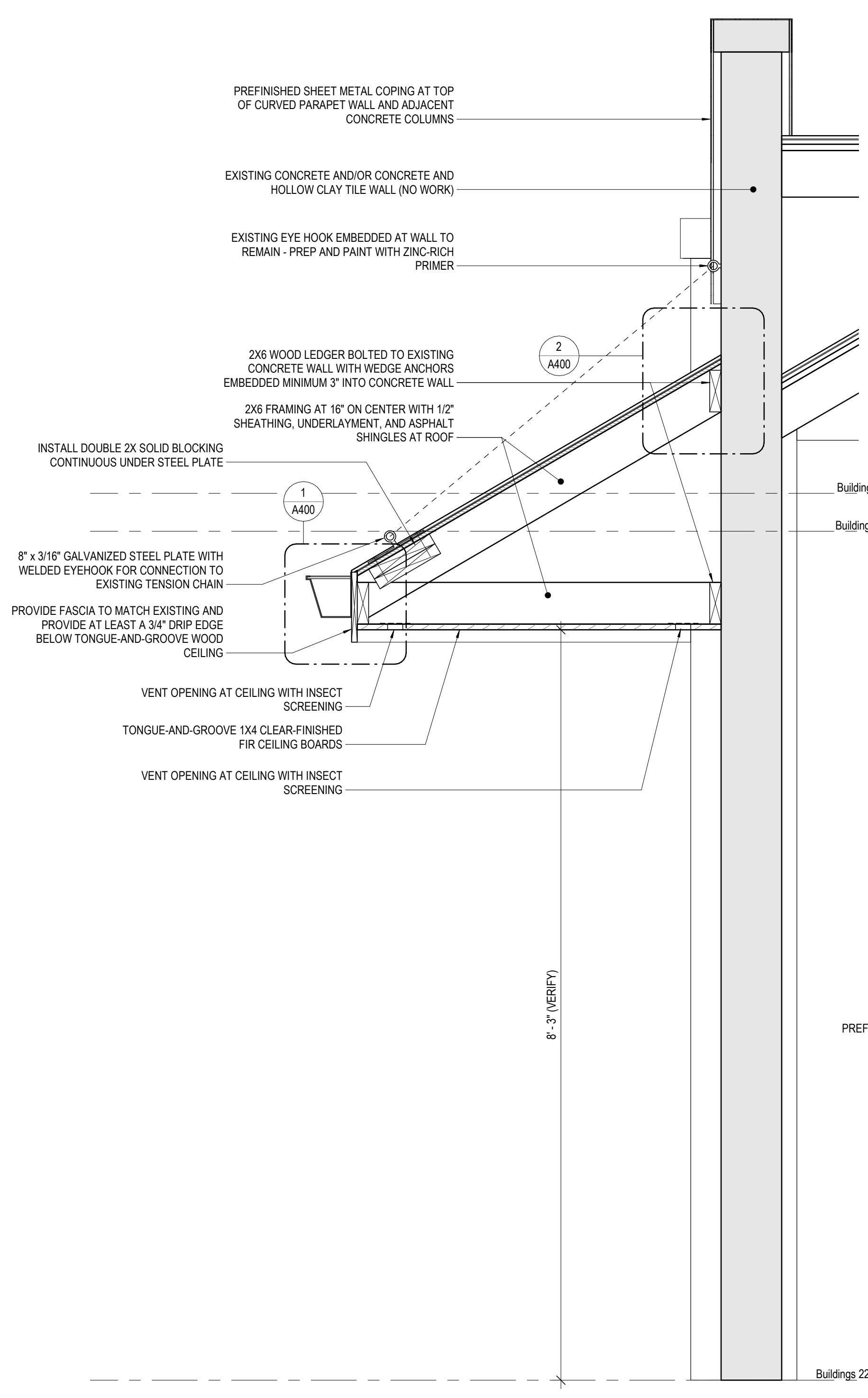

5 Building 22 Canopy Section
 1" = 1'-0"

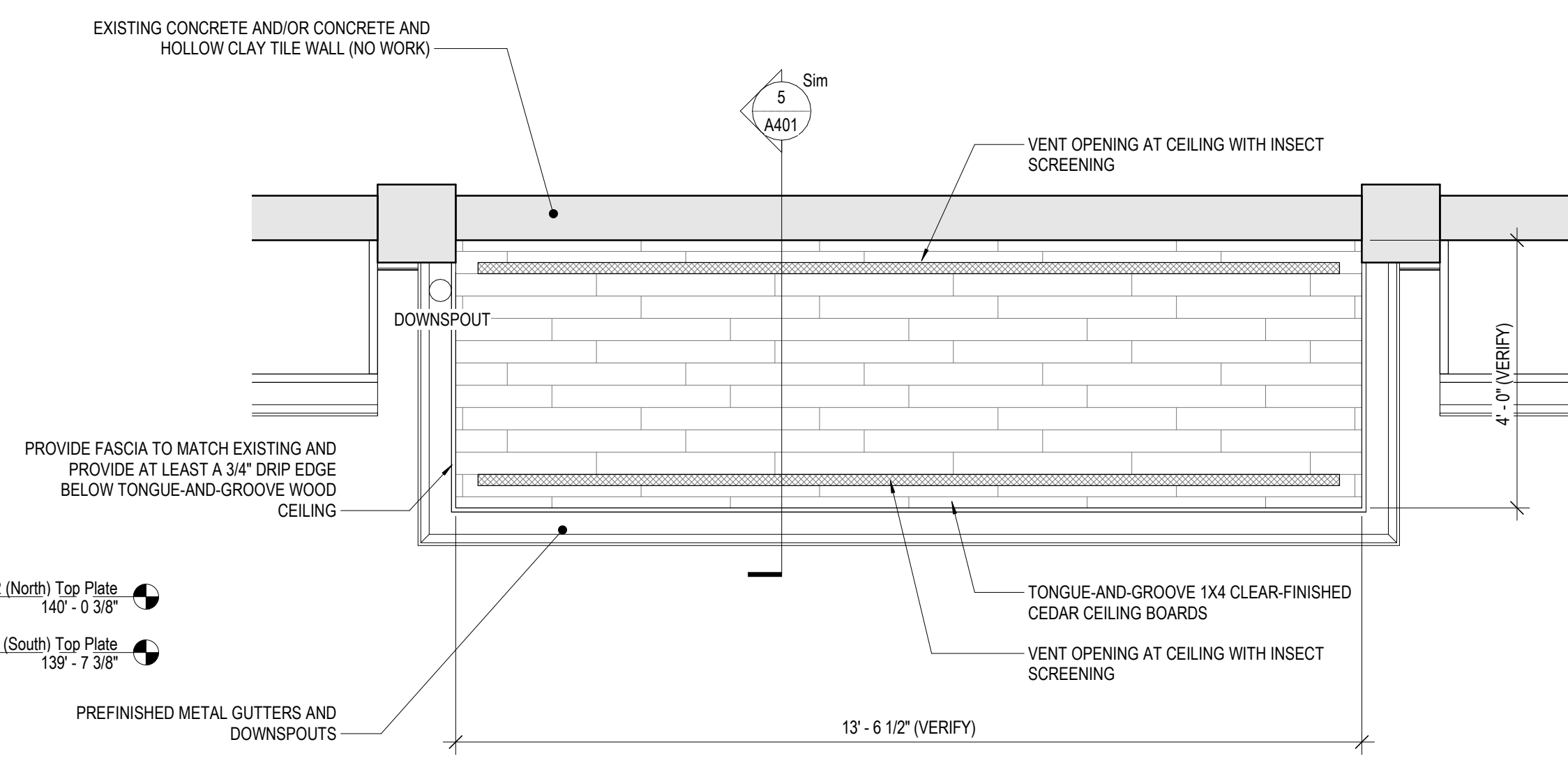

4 Building 22 (North) Enlarged Ceiling Plan at Canopy
 1/2" = 1'-0"

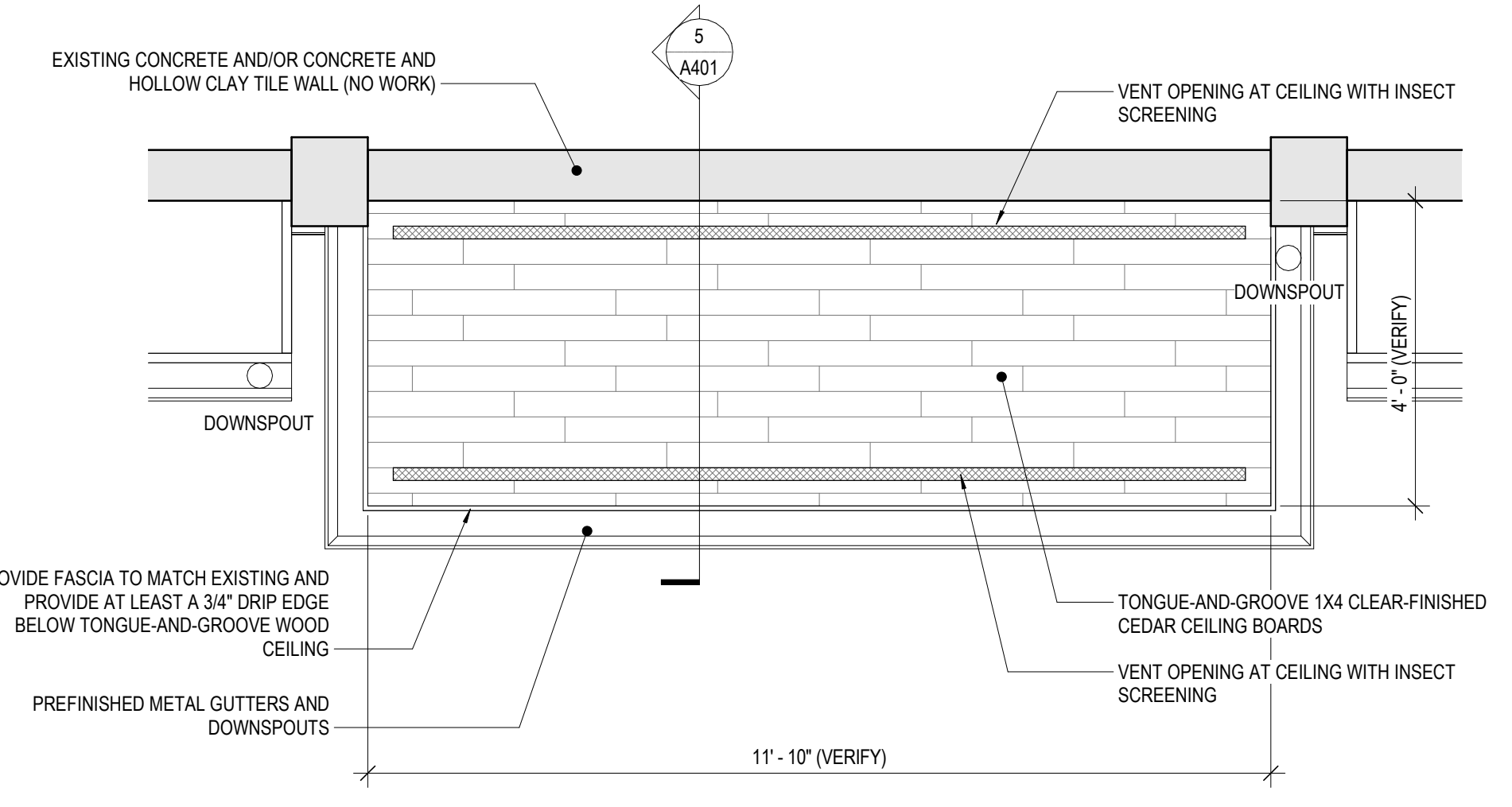

2 Building 22 (South) Enlarged Ceiling Plan at Canopy
 1/2" = 1'-0"

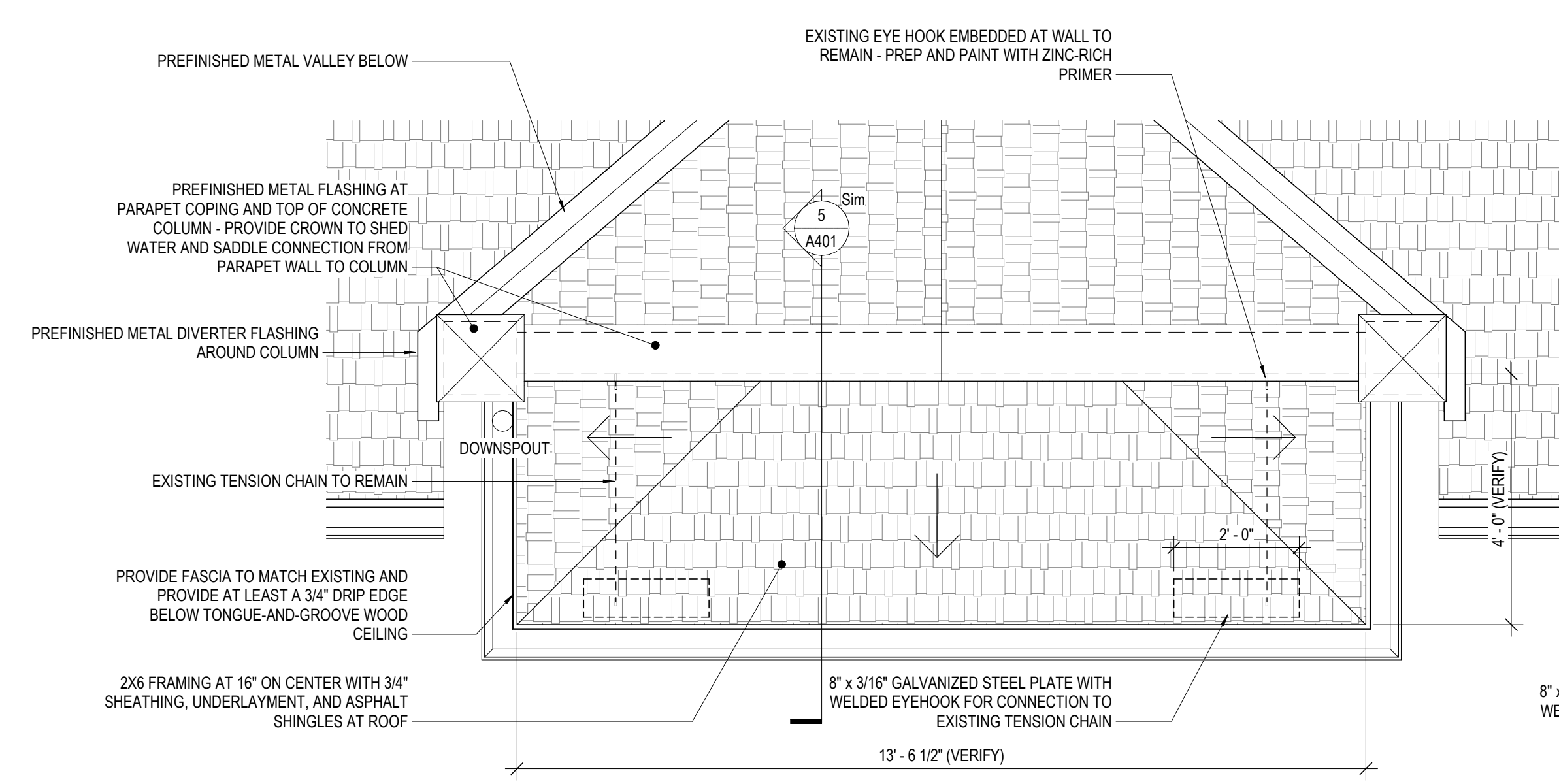

3 Building 22 (North) Enlarged Roof Plan at Canopy
 1/2" = 1'-0"

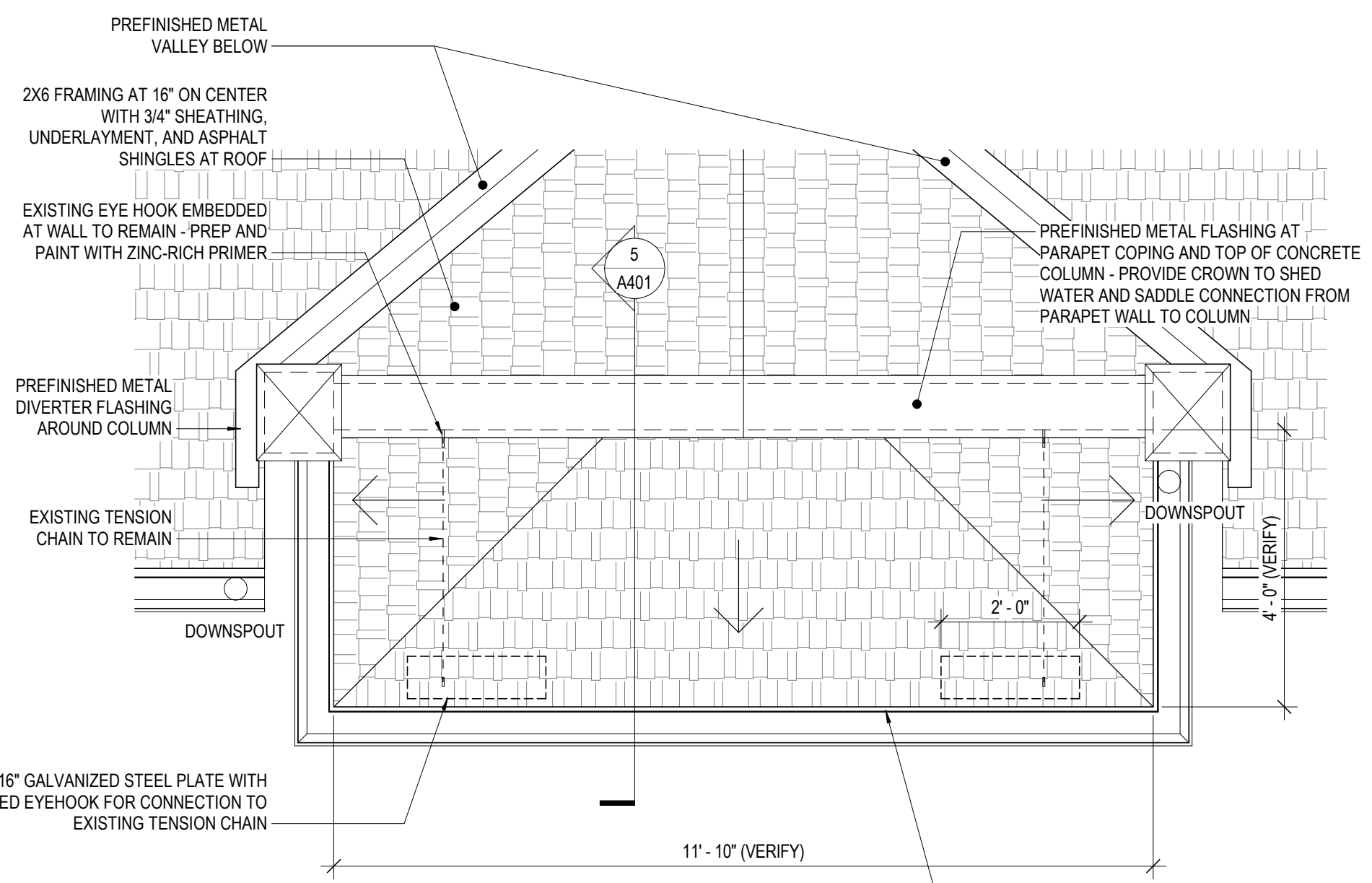

1 Building 22 (South) Enlarged Roof Plan at Canopy
 1/2" = 1'-0"

A401